

Install necessary applications :

Nautilus-elementary :

(source <http://www.webupd8.org/2011/03/install-nautilus-elementary-2322-in.html>)

Ubuntu 11.04 and 10.10

Add the Nautilus Elementary PPA and install the latest 2.32.2 in Ubuntu 11.04 Natty Narwhal and 10.10 Maverick Meerkat using the following commands:

```
sudo add-apt-repository ppa:am-monkeyd/nautilus-elementary-ppa
sudo apt-get update
sudo apt-get upgrade
```

"sudo apt-get upgrade" is required because Nautilus Elementary has some extra dependencies: ne-terminal-config and xterm.

Once installed, you must restart Nautilus using the following command:

```
nautilus -q
```

Ubuntu 10.04

Add the Nautilus Elementary PPA and install using the following commands :

```
sudo add-apt-repository ppa:am-monkeyd/nautilus-elementary-ppa/ubuntu
sudo apt-get update
sudo apt-get upgrade
```

"sudo apt-get upgrade" is required because Nautilus Elementary has some extra dependencies: ne-terminal-config and xterm.

Once installed, you must restart Nautilus using the following command:

```
nautilus -q
```

Gnome global menu applet : (not indispensable)

Ubuntu 10.10 Maverick Meerkat

Add the Gnome global menu applet PPA and install using the following commands:

```
sudo add-apt-repository ppa:nilarimogard/webupd8
sudo apt-get update
sudo apt-get install gnome-globalmenu
```

then logout / login and add to your panel gnome global menu applet.

Ubuntu 10.04

Add the Gnome global menu applet PPA and install using the following commands:

```
sudo add-apt-repository ppa:globalmenu-team/ppa
sudo apt-get update
sudo apt-get install gnome-globalmenu gnome-applet-globalmenu gnome-globalmenu-common
```

then logout / login and add to your panel gnome global menu applet.

GTK Engine murrine : include by default in ubuntu

Install themes and icons :

The theme :

Extract the archive in your home directory
And copy the folder to hidden directory **.themes**

The icons :

Extract the archive in your home directory
And copy the folder to hidden directory **.icons**

You can unhide the folders with **ctrl+h**

Configuration of nautilus :

Remove menu-bar :

if you have installed gnome global menu :
Right clic on your panel and add **applet menu global**

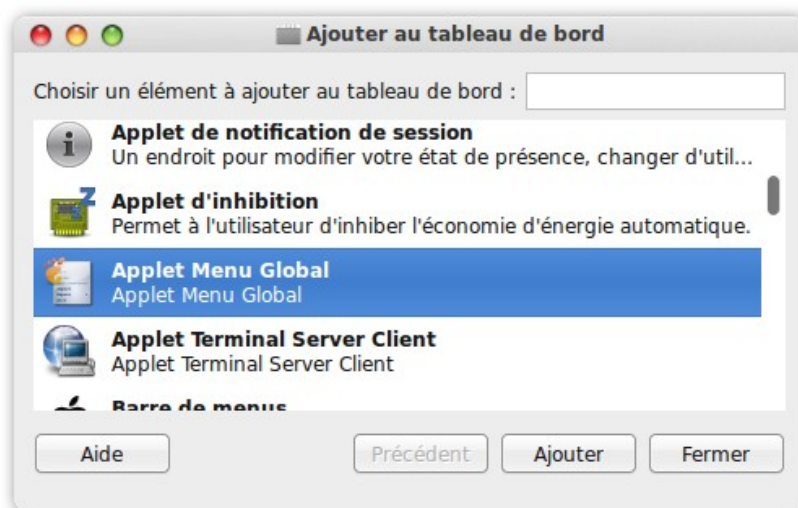

if you don't have install gnome global menu
Right clic on nautilus toolbar and uncheck **menubar**

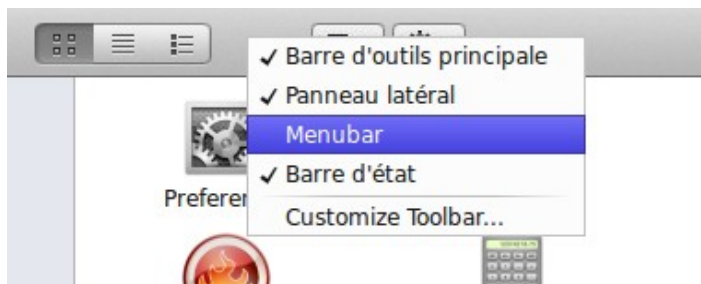

Set the buttons on the toolbar :

Right clic on nautilus toolbar and select **customize toolbar**

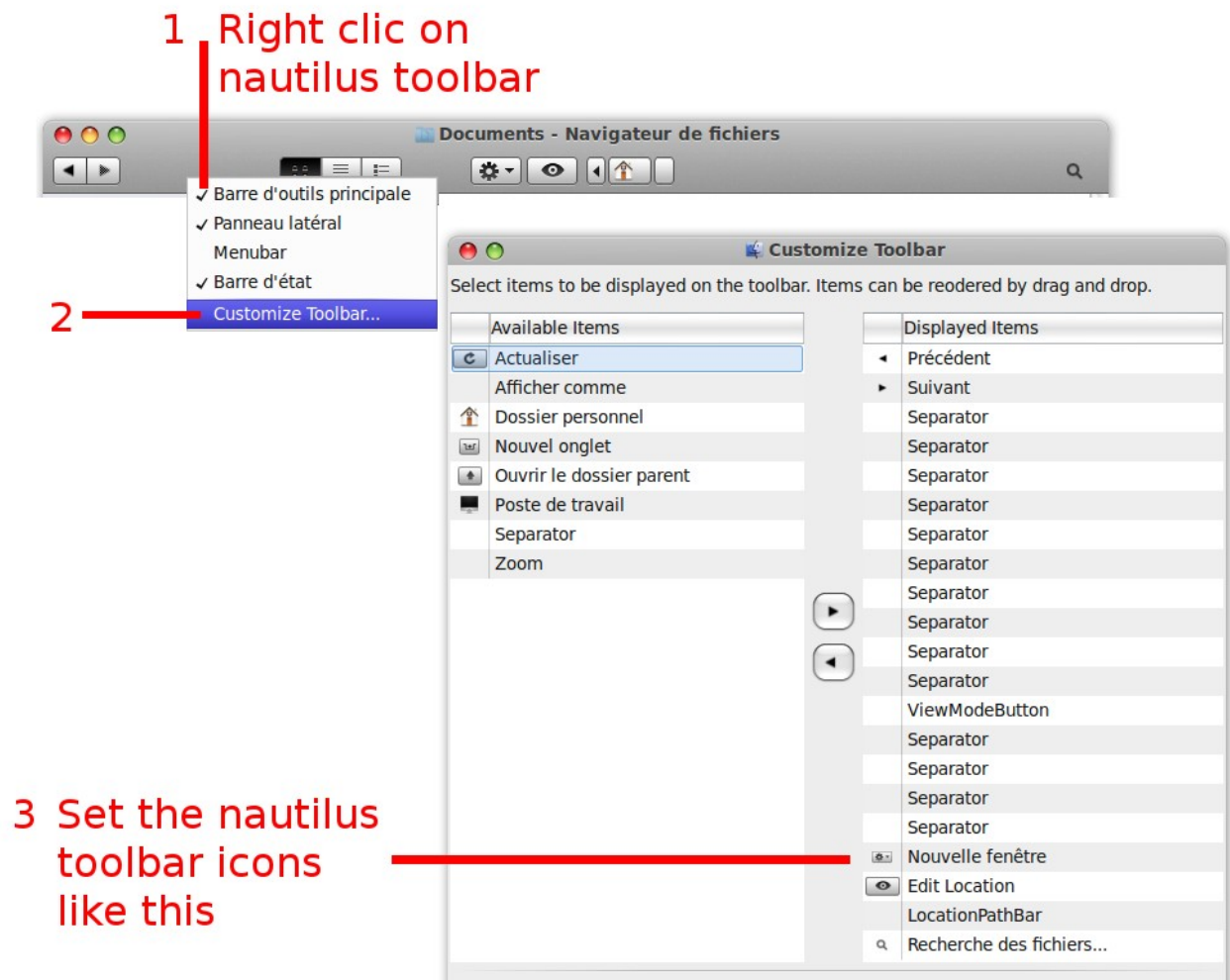

Back ; Forward ; separator x10 ; viewmodebutton ; separator x4 ; new window ; edit location ; locationpathbar ; search.